

P:\2012\Drawings\Plan\2812 - Cover Sheet.dwg

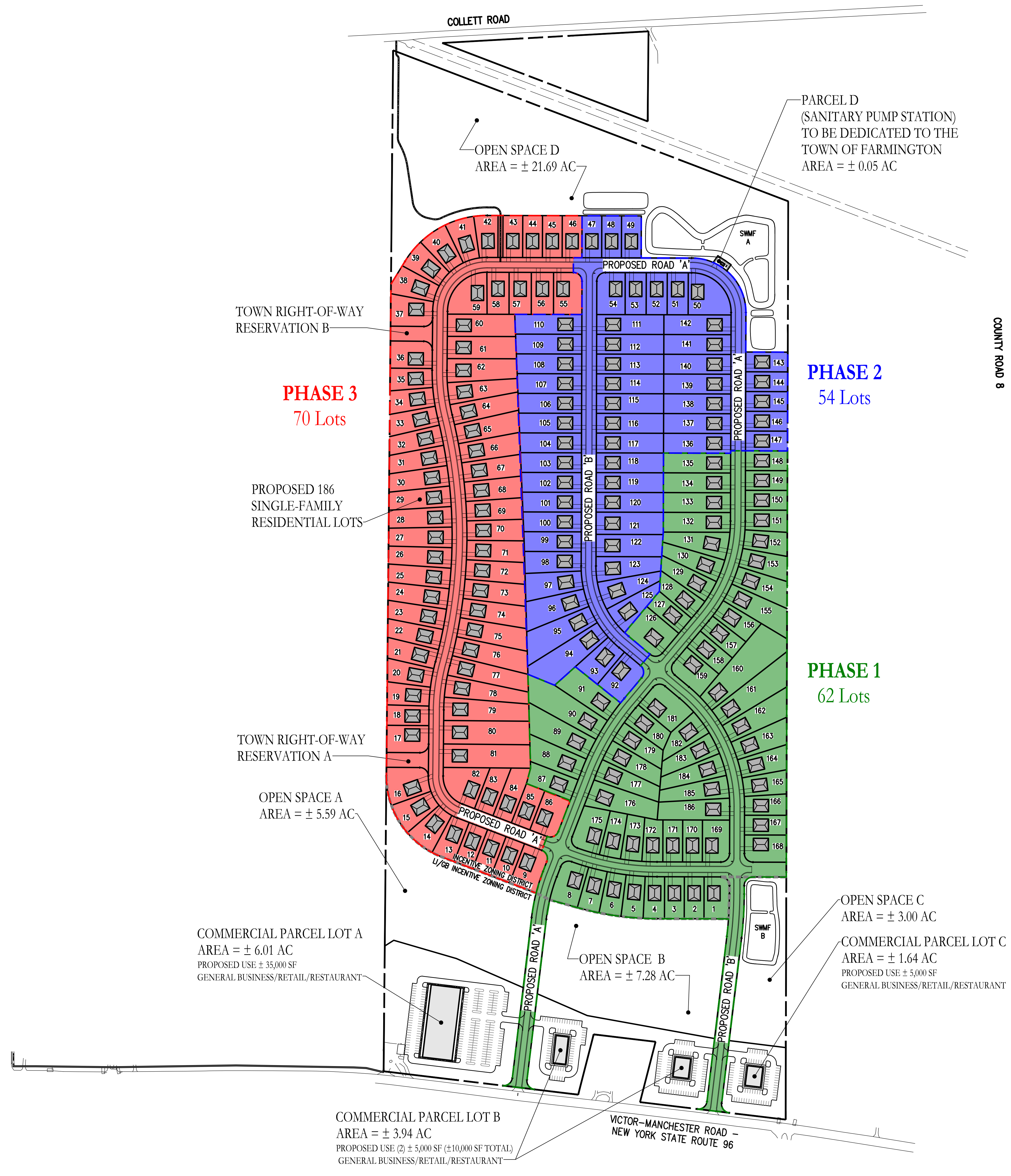
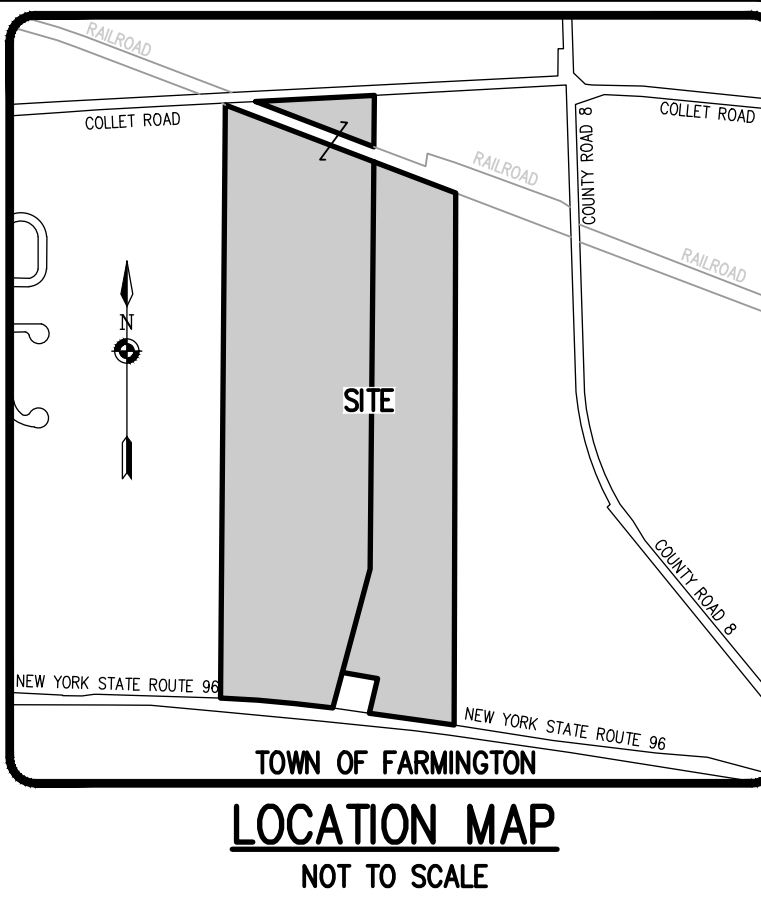

### OVERALL PRELIMINARY SITE AND SUBDIVISION PLANS PADDOCK LANDING

DWG. No.	TITLE	DWG. No.	TITLE
2812-10	COVER SHEET	2812-22	CONSTRUCTION EROSION CONTROL PLAN (1 OF 3)
2812-11	SUBDIVISION PLAT (1 OF 4)	2812-23	CONSTRUCTION EROSION CONTROL PLAN (2 OF 3)
2812-12	SUBDIVISION PLAT (2 OF 4)	2812-24	CONSTRUCTION EROSION CONTROL PLAN (3 OF 3)
2812-13	SUBDIVISION PLAT (3 OF 4)	2812-25	LANDSCAPE & LIGHTING PLAN (1 OF 3)
2812-14	SUBDIVISION PLAT (4 OF 4)	2812-26	LANDSCAPE & LIGHTING PLAN (2 OF 3)
2812-15	SITE AND UTILITY PLAN (1 OF 3)	2812-27	LANDSCAPE & LIGHTING PLAN (3 OF 3)
2812-16	SITE AND UTILITY PLAN (2 OF 3)	2812-28	PROFILE SHEET (1 OF 3)
2812-17	SITE AND UTILITY PLAN (3 OF 3)	2812-29	PROFILE SHEET (2 OF 3)
2812-18	GRADING PLAN (1 OF 3)	2812-30	PROFILE SHEET (3 OF 3)
2812-19	GRADING PLAN (2 OF 3)	2812-31	PROFILE & NOTE SHEET
2812-20	GRADING PLAN (3 OF 3)	2812-32	DETAIL SHEET (1 OF 4)
2812-21	OFFSITE SIDEWALK AND SANITARY FORCEMAIN PLAN	2812-33	DETAIL SHEET (2 OF 4)
		2812-34	DETAIL SHEET (3 OF 4)
		2812-35	DETAIL SHEET (4 OF 4)

# PADDOCK LANDING

## OVERALL PRELIMINARY SITE AND SUBDIVISION PLANS

TOWN OF FARMINGTON, ONTARIO COUNTY, NEW YORK

PREPARED FOR:  
**CANANDAIGUA DEVELOPMENT COMPANY LLC.**  
83 SOUTH MAIN STREET  
CANANDAIGUA, NEW YORK 14424

**NOT APPROVED**  
This plan has not received final approval of all reviewing agencies. This plan is subject to revisions until all approvals are obtained and should not be used for construction purposes.

**APPROVALS**

BY: TOWN ENGINEER	DATE: _____
BY: HIGHWAY SUPERINTENDENT	DATE: _____
BY: WATER AND SEWER SUPERINTENDENT	DATE: _____
BY: PLANNING BOARD CHAIRMAN	DATE: _____

SCALE: 1" = 200'  
DRAWING NUMBER: 2812-10  
DATED: NOVEMBER 9, 2023

**BME ASSOCIATES**  
ENGINEERS • SURVEYORS • LANDSCAPE ARCHITECTS  
10 LEFT BRIDGE LANE EAST  
FAIRPORT, NEW YORK 14450  
PHONE 585-377-7360  
FAX 585-377-7369  
WWW.BMEPC.COM